

10th IEEE ESTC
September 11-13, 2024
Mercure MOA Hotel,
Berlin-Moabit, Germany

Exhibition Plan
Booth Allocation

Status: 06.09.2024

Atrium / Main Hall

Security Fire Curtain
(down to 1,80 m above ground)

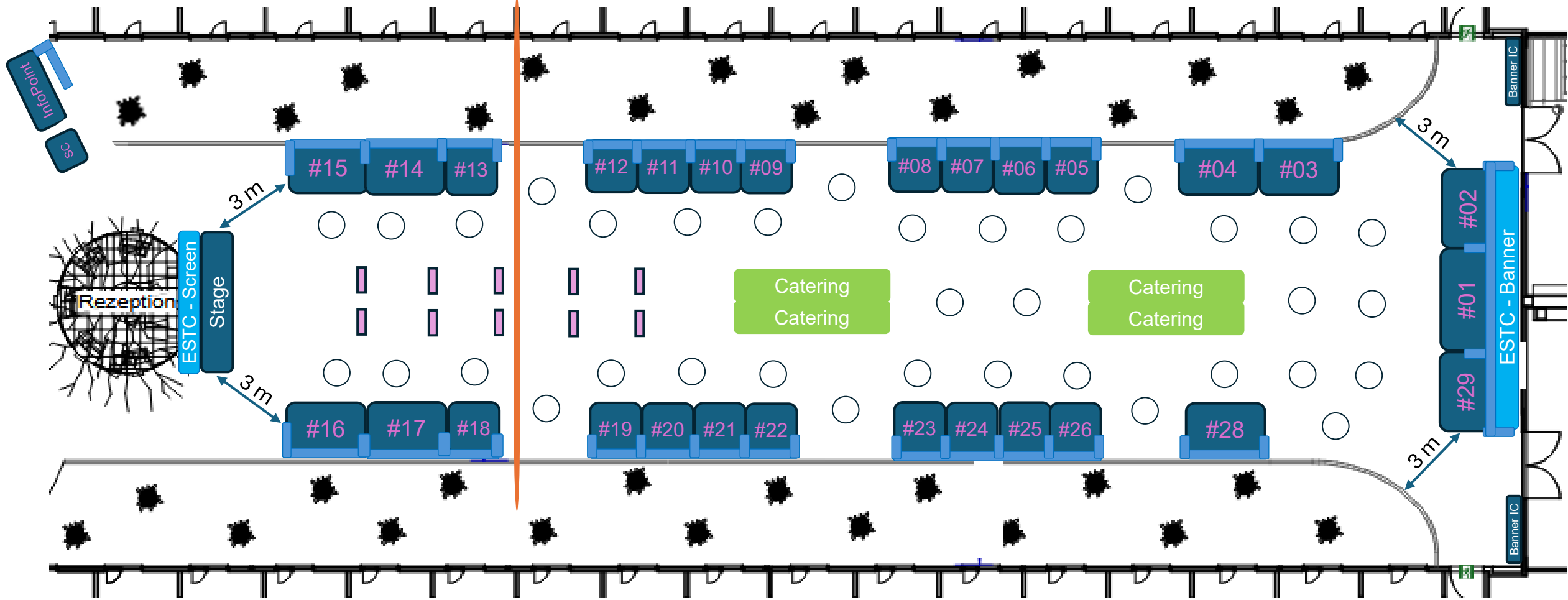

- 1 x Premium+ (4x2 m²)
- 9 x Premium (3x2 m²)
- 18 x Standard (2x2 m²)



- Back Wall/ Lights/ Roof/ Signate
- Side Walls into open space (50 cm max)
- Open Booth Space



- Mobile Poster Walls (double-sided) during Poster Presentation Sessions (3 session x 24 poster), placed here for extra traffic in the exhibition

Exhibition Room II with TableTop Area

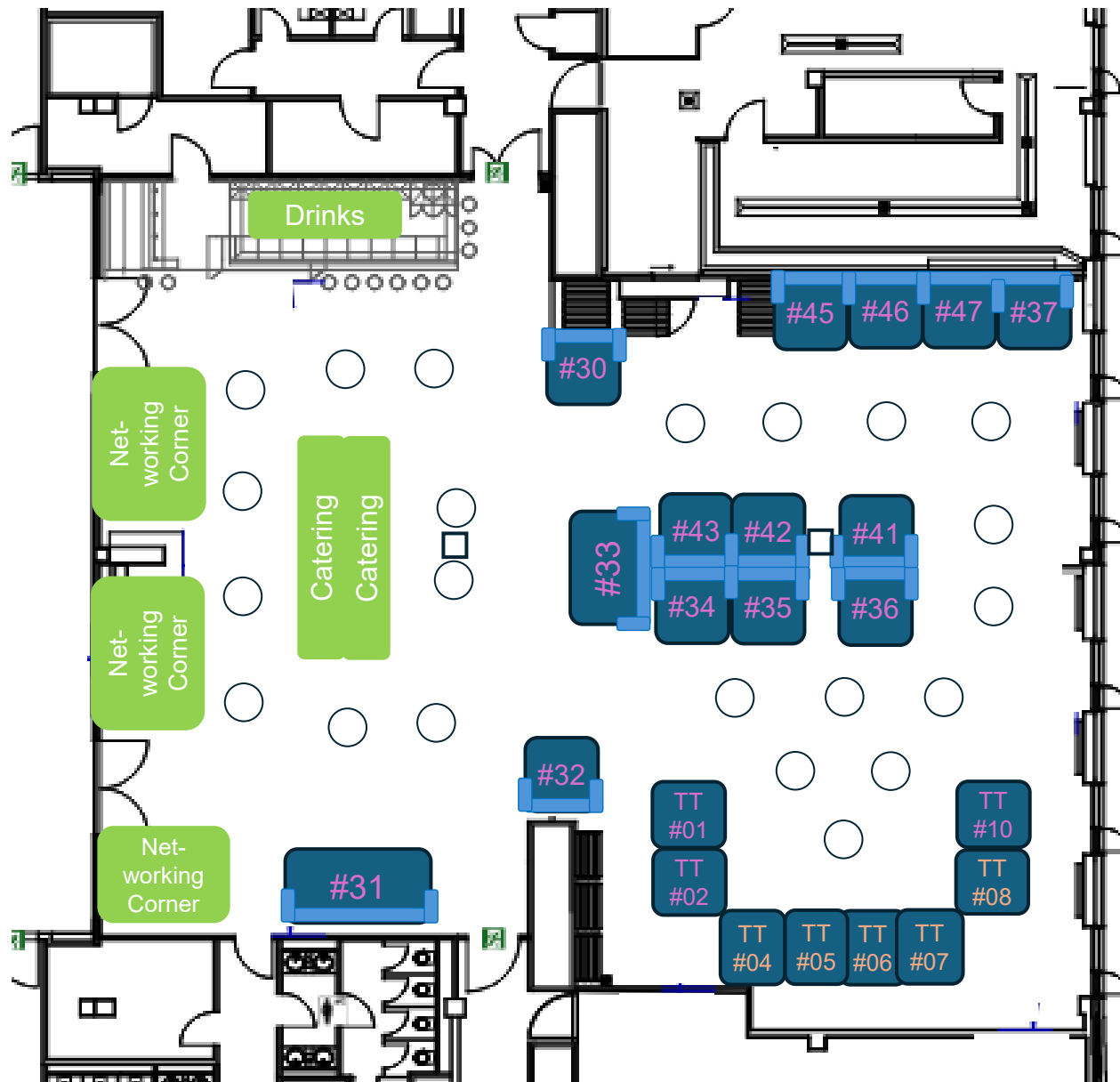

- 1 x MediaPartner Stand (4x2 m²)
- 1 x Premium (3x2 m²)
- 12 x Standard (2x2 m²)
- 8 x TableTop (TT) (1,6x2 m²)

-  - Back Wall/ Lights/ Roof/ Signage
- Side Walls into open space (50 cm max)
- Open Booth Space
-  - TableTop Exhibition Stand
- Orange Text = "University Corner"

TOTAL – FINAL (updated 05.09.2024)

- 2 x Premium+ (4x2 m²)
- 10 x Premium (3x2 m²)
- 30 x Standard (2x2 m²)
- 8 x TableTop (TT) (1,6x2 m²)

Removed from Layout = Reserve

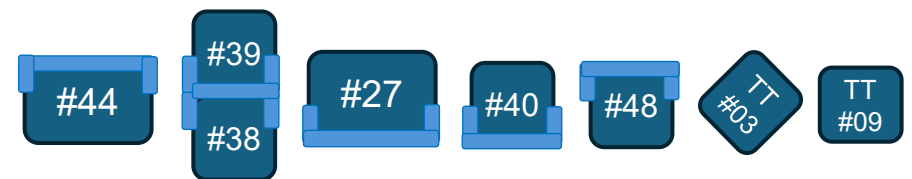

#01: AEMtec (4 m)

#02: PacTech

#03: Fraunhofer IZM

#04: Forschungsfabrik Mikroelektronik Deutschland (FMD)

#05: CEA Leti

#06: SAL

#07: SARCINA Technology

#08: Infineon / IPCEI ME/CT

#09: ROARTIS

#10: TOWA Europe

#11: SET

#12: ERS

#13: Besi

#14: TRESKY Automation

#15: finetech

#16: LIEB

#17: PLANOPTIK

#18: ALTER

#19: Koh Young Europe

#20: Electron Mec

#21: nanotec international GmbH

#22: DISCO HI-TEC EUROPE GmbH

#23: SCHOTT

#24: SCHMID Group

#25: Heidelberg Instruments

#26: LPKF

#27: REMOVED

#28: 3DiS Technologies

#29: ASE

----- EXHIBITION ROOM II -----

#30: IEEE EPS

#31: Media Partner (4 m)

#32: IMAPS Europe

#33: Fraunhofer ENAS

#34: SMART HIGH TECH

#35: DELO

#36: TAZMO, Co.,Ltd

#37: SUSS MicroTec

#38: REMOVED

#39: REMOVED

#40: REMOVED

#41: iNEMI (International Electronics Manufacturing Initiative)

#42: LINTEC

#43: eurofins MASER

#44: REMOVED

#45: budatec GmbH

#46: Daicel Corporation

#47: AMADYNE GmbH

#48: REMOVED

----- TableTop Area -----

T#01: Lidrotec

T#02: SENTECH

T#03: REMOVED

T#04: University Corner – TU Dresden + AVT

T#05: University Corner – Romania: 4 Universities and APTE

T#06: University Corner - University of South-Eastern Norway

T#07: University Corner – TU Delft + ECTM

T#08: University Corner – Technische Hochschule Ingolstadt

T#09: REMOVED

T#10: NANOTEST

#XX: 4 m PLATINUM
#XX: 3 m GOLD
#XX: 2 m SILVER
#XX: 3 m PREMIUM
#XX: 2 m STANDARD

Approved
Company Names
CW33 (15.08.24)
Request

Mercure MOA Hotel

CAD-Version (23.07.2024)

